

X3 Frequency Multiplier

ZX90-3-692+

50Ω Output 5100 to 6900 MHz

Maximum Ratings

Operating Temperature	-45°C to 85°C
Storage Temperature	-55°C to 100°C
RF Input Power	17 dBm

Permanent damage may occur if any of these limits are exceeded.

Coaxial Connections

INPUT	1
OUTPUT	2

Outline Drawing

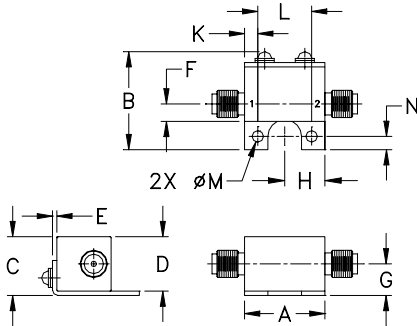

Outline Dimensions (inch/mm)

A	B	C	D	E	F	G
.74	.90	.54	.50	.04	.16	.29
18.80	22.86	13.72	12.70	1.02	4.06	7.37

H	J	K	L	M	N	wt
.37	--	.122	.496	.106	.122	grams
9.40	--	3.10	12.60	2.69	3.10	19.0

Features

- broadband
- low conversion loss, 14.7 dB typ.
- high rejection F2, 40 dBc typ., F4, 40 dBc typ.
- protected by US Patent 6,790,049

Applications

- synthesizers
- local oscillators
- satellite up and down converters



CASE STYLE: JA1242

Connectors	Model	Price	Qty.
SMA	ZX90-3-692-S+	\$41.95	(1-9)

+ RoHS compliant in accordance with EU Directive (2002/95/EC)

The +Suffix has been added in order to identify RoHS Compliance. See our web site for RoHS Compliance methodologies and qualifications.

Electrical Specifications

MULTIPLICATION FACTOR	FREQUENCY (MHz)		INPUT POWER (dBm)		CONVERSION LOSS (dB)	*HARMONIC OUTPUT (dBc)						
	F1 Input	F3 Output	Min.	Max.		F1		F2		F4		
3	1700-2300	5100-6900	9	13	14.7	20	40	29	40	25	40	25

* Harmonics of input frequency below the power level of F3

Typical Performance Data

Input Frequency (MHz)	INPUT RF= 9 dBm				INPUT RF= 13 dBm			
	Conversion Loss (dB)	Harmonic Output Below F3 (-dBc)			Conversion Loss (dB)	Harmonic Output Below F3 (-dBc)		
		F1	F2	F4		F1	F2	F4
1700.00	17.66	45.09	38.29	30.95	17.20	46.26	42.35	37.26
1740.00	16.91	42.47	43.03	33.81	16.83	44.67	45.43	41.48
1780.00	16.54	40.32	47.74	35.67	16.25	43.20	48.36	43.12
1820.00	15.81	39.19	52.11	38.92	15.40	42.43	49.87	47.84
1860.00	15.07	38.57	50.31	42.93	14.90	41.61	51.99	47.31
1900.00	14.51	38.08	47.88	45.91	14.30	41.07	49.21	46.19
1920.00	14.11	37.99	47.14	47.16	14.11	40.82	49.27	47.80
1955.00	13.67	37.69	45.51	47.61	14.12	40.07	46.82	51.10
1990.00	13.63	37.07	44.16	48.80	13.68	39.71	42.91	53.60
2025.00	13.51	36.57	42.87	49.78	14.82	38.12	39.54	50.88
2060.00	13.55	36.12	41.51	50.68	14.98	37.56	36.44	47.05
2095.00	13.76	35.51	39.27	49.20	15.70	36.67	33.89	44.01
2130.00	13.85	35.14	37.68	47.32	15.79	36.23	32.14	38.63
2165.00	13.81	34.97	35.97	44.81	16.24	35.63	31.61	37.48
2200.00	14.16	34.62	34.71	42.48	16.54	35.24	31.37	36.94
2220.00	14.54	34.19	33.82	41.01	16.89	34.89	31.43	36.68
2240.00	14.70	34.06	33.21	39.49	17.45	34.34	31.26	35.98
2270.00	14.98	33.87	32.75	38.13	17.61	34.33	31.71	35.46
2300.00	15.18	33.94	32.13	36.76	17.84	34.29	32.61	37.36

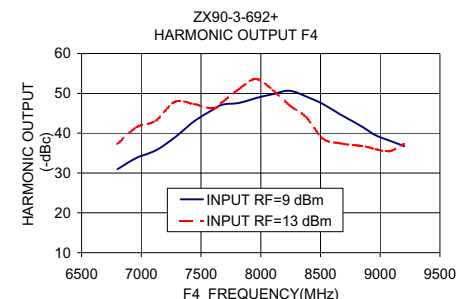
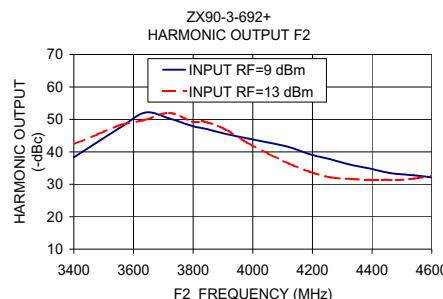
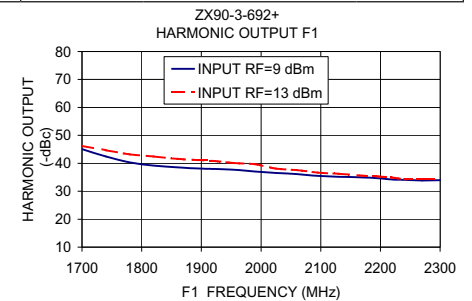
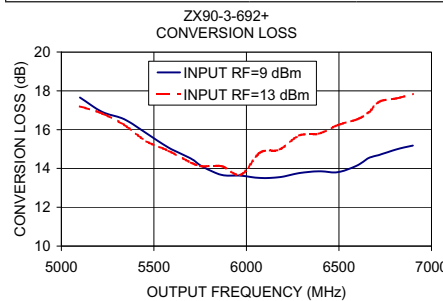

P.O. Box 350166, Brooklyn, New York 11235-0003 (718) 934-4500 Fax (718) 332-4661 The Design Engineers Search Engine



Provides ACTUAL Data Instantly at minicircuits.com

For detailed performance specs & shopping online see web site

Notes: 1. Performance and quality attributes and conditions not expressly stated in this specification sheet are intended to be excluded and do not form a part of this specification sheet. 2. Electrical specifications and performance data contained herein are based on Mini-Circuit's applicable established test performance criteria and measurement instructions. 3. The parts covered by this specification sheet are subject to Mini-Circuits standard limited warranty and terms and conditions (collectively, "Standard Terms"); Purchasers of this part are entitled to the rights and benefits contained therein. For a full statement of the Standard Terms and the exclusive rights and remedies thereunder, please visit Mini-Circuits' website at www.minicircuits.com/MCLStore/terms.jsp.

REV. OR
M110746
ZX90-3-692+
ED-12885A/3
DY/CP
081224