

# Power Splitter/Combiner

## ZC6PD-960W

6 Way-0° 50Ω 700 to 1000 MHz

### Maximum Ratings

Operating Temperature	-55°C to 100°C
Storage Temperature	-55°C to 100°C
Power Input (as a splitter)	10W max.
Internal Dissipation	0.875W max.

Permanent damage may occur if any of these limits are exceeded.

### Coaxial Connections

SUM PORT	S
PORT 1,2,3,4,5,6	1,2,3,4,5,6

### Outline Drawing

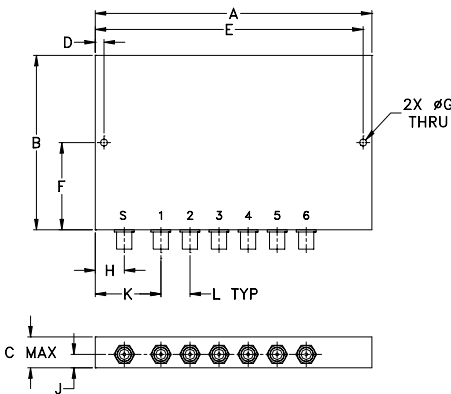

### Outline Dimensions (inch/mm)

A	B	C	D	E	F
4.76	3.00	.53	.150	4.610	1.500
120.90	76.20	13.46	3.81	117.09	38.10
G	H	J	K	L	wt
.125	.50	.25	1.13	.50	grams
3.18	12.70	6.35	28.70	12.70	155

### Features

- low insertion loss, 0.4 dB typ.
- high isolation, 28 dB typ.
- up to 10W power output as splitter
- rugged shielded case

### Applications

- UHF
- cellular
- instrumentation



CASE STYLE: AB185

Connectors	Model	Price	Qty.
SMA	ZC6PD-960W-S	\$119.95	(1-9)

### Electrical Specifications

FREQ. RANGE (MHz)	ISOLATION (dB)		INSERTION LOSS (dB) ABOVE 7.8 dB		PHASE UNBALANCE (Degrees)	AMPLITUDE UNBALANCE (dB)	VSWR (:1)			
	Typ.	Min.	Typ.	Max.			S		OUT	
$f_L$ - $f_U$					Max.	Max.	Typ.	Max.	Typ.	Max.
700-1000	28	15	0.4	1.0	—	0.6	1.3	1.5	1.2	1.5

### Typical Performance Data

Frequency (MHz)	Insertion Loss (dB)			Amplitude Unbalance (dB)	Isolation (dB)			Phase Unbal. (deg.)	VSWR S	VSWR 1	VSWR 3
	S-1	S-2	S-3		1-2	1-3	1-6				
700.00	8.04	8.04	7.85	0.21	22.53	20.27	25.29	2.51	1.04	1.05	1.06
720.00	8.02	8.01	7.84	0.19	24.03	21.27	25.61	2.35	1.03	1.06	1.07
750.00	8.09	8.08	7.92	0.18	26.76	22.97	26.38	2.46	1.11	1.07	1.08
780.00	8.09	8.08	7.95	0.15	30.06	24.62	27.14	2.22	1.18	1.08	1.09
805.00	8.01	7.98	7.87	0.14	33.76	26.10	27.90	2.38	1.22	1.09	1.10
820.00	8.03	8.00	7.91	0.14	36.88	27.12	28.45	2.37	1.25	1.10	1.11
835.00	8.16	8.13	8.03	0.13	41.45	28.24	29.12	2.47	1.26	1.11	1.12
850.00	8.25	8.23	8.15	0.12	48.78	29.47	29.82	2.35	1.27	1.12	1.13
865.00	8.15	8.11	8.08	0.11	46.78	30.74	30.43	2.25	1.27	1.13	1.14
880.00	8.05	8.01	7.99	0.08	40.30	32.33	31.07	2.36	1.26	1.14	1.15
895.00	8.07	8.01	8.01	0.08	36.33	34.25	31.75	2.46	1.25	1.14	1.15
910.00	8.09	8.03	8.03	0.07	33.44	37.01	32.42	2.55	1.24	1.15	1.16
930.00	8.14	8.09	8.10	0.06	30.64	42.09	33.16	2.52	1.21	1.16	1.17
960.00	8.10	8.05	8.11	0.06	27.31	39.90	33.43	2.49	1.15	1.17	1.18
1000.00	8.04	7.99	8.11	0.13	23.78	30.76	32.19	2.64	1.13	1.17	1.18

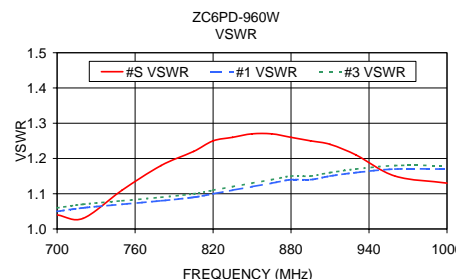
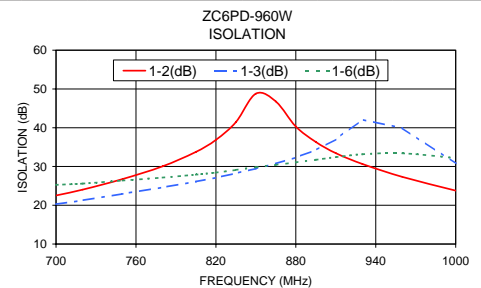
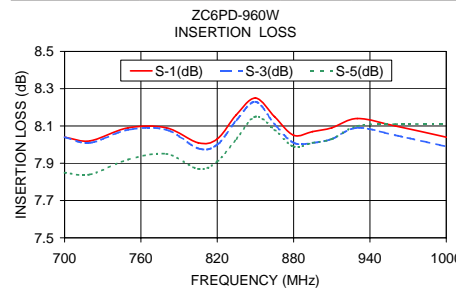

### electrical schematic

