

Power Splitter/Combiner

ZC6PD-960

6 Way-0° 50Ω 890 to 960 MHz

Maximum Ratings

Operating Temperature	-55°C to 100°C
Storage Temperature	-55°C to 100°C
Power Input (as a splitter)	10W max.
Internal Dissipation	0.875W max.

Permanent damage may occur if any of these limits are exceeded.

Coaxial Connections

SUM PORT	S
PORT 1,2,3,4,5,6	1,2,3,4,5,6

Outline Drawing

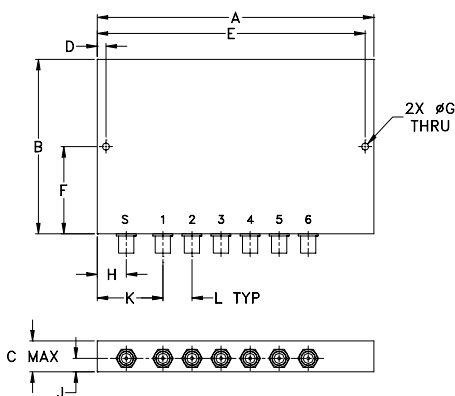

Outline Dimensions (inch/mm)

A	B	C	D	E	F
4.76	3.00	.53	.150	4.610	1.500
120.90	76.20	13.46	3.81	117.09	38.10
G	H	J	K	L	wt
.125	.50	.25	1.13	.50	grams
3.18	12.70	6.35	28.70	12.70	155

Features

- low insertion loss, 0.4 dB typ.
- high isolation, 30 dB typ.
- excellent VSWR, output, 1.1:1 typ.
- up to 10W power input as splitter
- rugged shielded case

Applications

- cellular
- signal processing
- instrumentation



CASE STYLE: AB185

Connectors	Model	Price	Qty.
SMA	ZC6PD-960-S	\$124.95	(1-9)

Electrical Specifications

FREQ. RANGE (MHz)	ISOLATION (dB)		INSERTION LOSS (dB) ABOVE 7.8 dB		PHASE UNBALANCE (Degrees)	AMPLITUDE UNBALANCE (dB)	VSWR (:1)			
	Typ.	Min.	Typ.	Max.			S		OUT	
f _L -f _U					Max.	Max.	Typ.	Max.	Typ.	Max.
890-960	30	20	0.4	0.8	—	0.4	1.2	1.5	1.1	1.5

Typical Performance Data

Frequency (MHz)	Insertion Loss (dB)			Amplitude Unbalance (dB)	Isolation (dB)			Phase Unbal. (deg.)	VSWR S	VSWR 1	VSWR 3
	S-1	S-2	S-3		1-2	1-3	1-4				
890.00	8.01	8.12	7.98	0.14	30.27	28.32	43.72	8.08	1.14	1.06	1.04
892.00	8.01	8.09	7.96	0.15	30.53	28.50	43.10	8.10	1.14	1.07	1.04
895.00	8.01	8.10	7.97	0.13	30.85	28.77	42.52	8.18	1.14	1.07	1.04
898.00	8.01	8.10	7.99	0.14	31.24	29.09	41.78	8.18	1.13	1.07	1.04
902.00	8.02	8.09	7.98	0.14	31.77	29.47	40.94	8.27	1.13	1.08	1.04
908.00	8.02	8.09	7.98	0.15	32.69	30.15	39.79	8.32	1.13	1.09	1.05
914.00	8.04	8.12	8.02	0.15	33.68	30.88	38.83	8.30	1.12	1.09	1.06
920.00	8.02	8.12	8.02	0.12	34.85	31.60	37.87	8.41	1.12	1.10	1.07
926.00	8.03	8.13	8.03	0.12	36.13	32.48	37.15	8.33	1.11	1.10	1.07
932.00	8.04	8.12	8.05	0.11	37.64	33.36	36.41	8.29	1.10	1.10	1.08
938.00	8.02	8.12	8.07	0.14	39.39	34.45	35.71	8.44	1.09	1.10	1.08
942.00	8.00	8.12	8.08	0.14	40.94	35.25	35.30	8.38	1.09	1.09	1.08
946.00	8.01	8.12	8.09	0.14	42.54	36.05	34.87	8.34	1.09	1.09	1.08
952.00	7.99	8.09	8.08	0.14	45.64	37.64	34.21	8.40	1.10	1.08	1.07
960.00	7.96	8.09	8.08	0.15	49.99	40.07	33.44	8.50	1.11	1.08	1.06

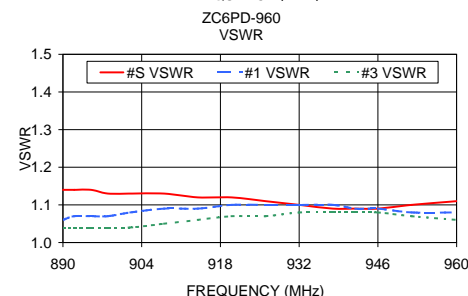
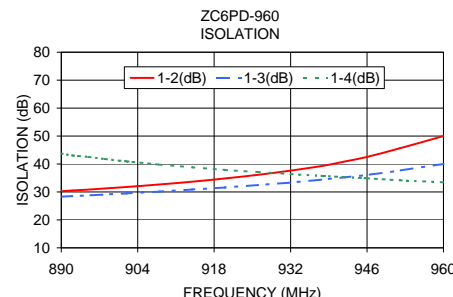
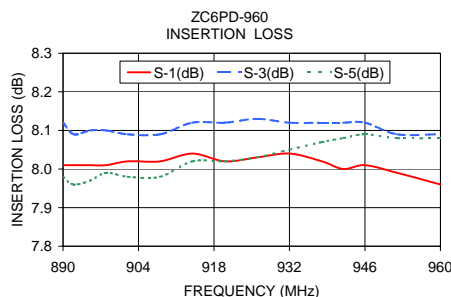

electrical schematic



For detailed performance specs & shopping online see web site

P.O. Box 350166, Brooklyn, New York 11235-0003 (718) 934-4500 Fax (718) 332-4661 The Design Engineers Search Engine Provides ACTUAL Data Instantly at minicircuits.com

Notes: 1. Performance and quality attributes and conditions not expressly stated in this specification sheet are intended to be excluded and do not form a part of this specification sheet. 2. Electrical specifications and performance data contained herein are based on Mini-Circuit's applicable established test performance criteria and measurement instructions. 3. The parts covered by this specification sheet are subject to Mini-Circuits standard limited warranty and terms and conditions (collectively, "Standard Terms"); Purchasers of this part are entitled to the rights and benefits contained therein. For a full statement of the Standard Terms and the exclusive rights and remedies thereunder, please visit Mini-Circuits' website at www.minicircuits.com/MCLStore/terms.jsp.

REV. OR
M96283
ZC6PD-960
HY/TD/CP
090827