

Coaxial

# Power Splitter/Combiner

## ZB6PD1-1900

6 Way-0° 50Ω 1700 to 1900 MHz

### Maximum Ratings

Operating Temperature	-55°C to 100°C
Storage Temperature	-55°C to 100°C
Power Input (as a splitter)	10W max.
Internal Dissipation	0.5W max.

Permanent damage may occur if any of these limits are exceeded.

### Coaxial Connections

SUM PORT	S
PORT 1,2,3,4,5,6	1,2,3,4,5,6

### Outline Drawing

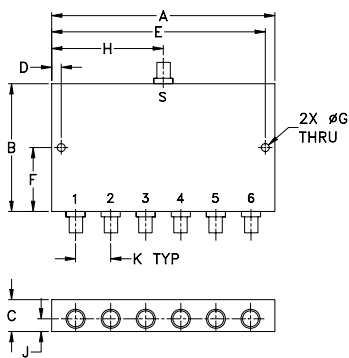

### Outline Dimensions (inch/mm)

A	B	C	D	E	F
6.00	1.62	.88	.250	5.750	.810
152.40	41.15	22.35	6.35	146.05	20.57
G	H	J	K	wt	
.144	3.00	.44	1.00	grams	
3.66	76.20	11.18	25.40	340	

### Features

- low insertion loss, 0.4 dB typ.
- high isolation, 32 dB typ.
- excellent VSWR, 1.1:1 typ.
- rugged shielded case
- up to 10W power input as splitter

### Applications

- PCS/DCS
- communications systems
- instrumentation



CASE STYLE: UU187

Connectors	Model	Price	Qty.
SMA	ZB6PD1-1900-S	\$149.95	(1-9)
N-TYPE	ZB6PD1-1900-N	\$149.95	(1-9)

### Electrical Specifications

FREQ. RANGE (MHz)	ISOLATION (dB)		INSERTION LOSS (dB) ABOVE 7.8 dB		AMPLITUDE UNBALANCE (dB)	VSWR (:1)			
	Typ.	Min.	Typ.	Max.		S		OUT	
f <sub>L</sub> -f <sub>U</sub>					Max.	Typ.	Max.	Typ.	Max.
1700-1900	32	20	0.4	0.8	0.6	1.1	1.3	1.09	1.4

### Typical Performance Data

Frequency (MHz)	Insertion Loss (dB)	Amplitude Unbalance (dB)	Isolation (dB)		VSWR S	VSWR OUTPUTS
			Adjacent	Opposite		
1700.00	7.88	0.21	33.71	33.10	1.12	1.10
1715.50	7.88	0.20	34.95	33.70	1.12	1.10
1731.00	7.85	0.20	36.27	34.13	1.12	1.10
1746.00	7.83	0.17	37.81	34.76	1.12	1.10
1761.00	7.84	0.20	40.02	35.34	1.11	1.11
1777.00	7.91	0.17	42.84	36.27	1.11	1.11
1792.50	7.89	0.13	45.17	36.97	1.11	1.11
1807.50	7.91	0.13	44.54	37.90	1.11	1.11
1823.00	7.90	0.17	41.92	38.94	1.11	1.11
1838.50	7.88	0.15	39.17	39.91	1.11	1.10
1854.00	7.93	0.13	36.55	41.27	1.11	1.10
1869.00	7.95	0.12	34.68	43.01	1.10	1.10
1884.50	7.99	0.13	33.06	44.69	1.10	1.10
1895.00	8.03	0.12	32.02	46.45	1.11	1.10
1900.00	7.97	0.13	31.53	47.29	1.11	1.10

ZB6PD1-1900 INSERTION LOSS

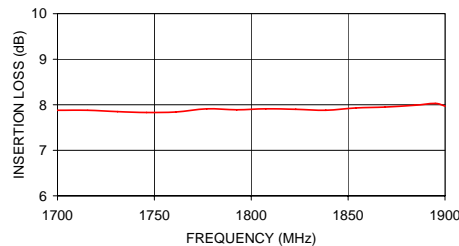

ZB6PD1-1900 ISOLATION

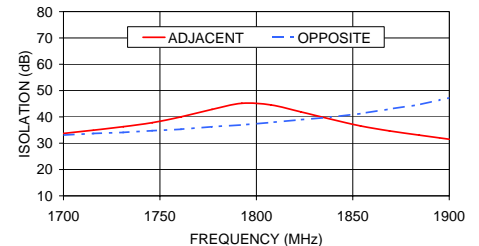

ZB6PD1-1900 VSWR

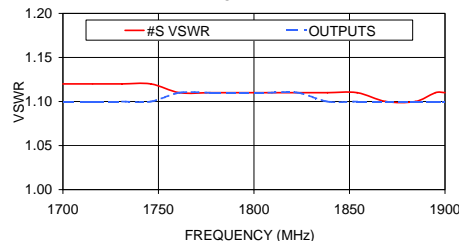

### electrical schematic



For detailed performance specs & shopping online see web site

P.O. Box 350166, Brooklyn, New York 11235-0003 (718) 934-4500 Fax (718) 332-4661 The Design Engineers Search Engine Provides ACTUAL Data Instantly at [minicircuits.com](http://minicircuits.com)

Notes: 1. Performance and quality attributes and conditions not expressly stated in this specification sheet are intended to be excluded and do not form a part of this specification sheet. 2. Electrical specifications and performance data contained herein are based on Mini-Circuit's applicable established test performance criteria and measurement instructions. 3. The parts covered by this specification sheet are subject to Mini-Circuits standard limited warranty and terms and conditions (collectively, "Standard Terms"); Purchasers of this part are entitled to the rights and benefits contained therein. For a full statement of the Standard Terms and the exclusive rights and remedies thereunder, please visit Mini-Circuits' website at [www.minicircuits.com/MCLStore/terms.jsp](http://www.minicircuits.com/MCLStore/terms.jsp).

REV. OR  
M96283  
ZB6PD1-1900  
HY/TD/CP  
090827