

Coaxial

Power Splitter/Combiner

ZB4PD1-500+

4 Way-0° 50Ω 5 to 500 MHz

Maximum Ratings

Operating Temperature	-55°C to 100°C
Storage Temperature	-55°C to 100°C
Power Input (as a splitter)	1W max.
Internal Dissipation	0.250W max.

Permanent damage may occur if any of these limits are exceeded.

Coaxial Connections

SUM PORT	S
PORT 1	1
PORT 2	2
PORT 3	3
PORT 4	4

Outline Drawing

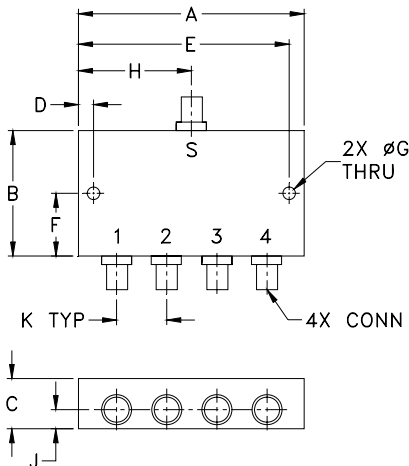

Outline Dimensions (inch/mm)

A	B	C	D	E	F
3.50	2.13	.88	.150	3.350	1.06
88.90	54.10	22.35	3.81	85.09	26.92
G	H	J	K	wt	
.125	1.75	.44	.89	grams	
3.18	44.45	11.18	22.61	260	

Features

- wideband, 5 to 500 MHz
- high isolation, 34 dB typ.
- rugged, shielded case

Applications

- VHF/UHF
- receivers/transmitters



SMA version shown
CASE STYLE: UU188

Connectors	Model	Price	Qty.
BNC	ZB4PD1-500+	\$79.95	(1-9)
SMA	ZB4PD1-500-S+	\$94.95	(1-9)
N-TYPE	ZB4PD1-500-N+	\$94.95	(1-9)

+ RoHS compliant in accordance with EU Directive (2002/95/EC)

The +Suffix has been added in order to identify RoHS Compliance. See our web site for RoHS Compliance methodologies and qualifications.

Electrical Specifications

FREQ. RANGE (MHz)	ISOLATION (dB)						INSERTION LOSS (dB) ABOVE 6.0 dB						PHASE UNBALANCE (Degrees)			AMPLITUDE UNBALANCE (dB)		
	L		M		U		L		M		U		L	M	U	L	M	U
	Typ.	Min.	Typ.	Min.	Typ.	Min.	Typ.	Max.	Typ.	Max.	Typ.	Max.	Max.	Max.	Max.	Max.	Max.	Max.
5-500	34	20	34	20	28	20	0.4	1.0	0.5	0.9	0.9	1.5	1	3	6	0.2	0.2	0.4

L = low range [f_L to $10 f_L$] M = mid range [$10 f_L$ to $f_U/2$] U = upper range [$f_U/2$ to f_U]

Typical Performance Data

Freq. (MHz)	Insertion Loss (dB)				Amp. Unbal. (dB)	Isolation (dB)			VSWR	VSWR	VSWR	VSWR	VSWR
	S-1	S-2	S-3	S-4		1-2	2-3	3-4	S	1	2	3	4
5.00	6.34	6.35	6.33	6.33	0.01	52.83	40.68	50.23	1.08	1.12	1.12	1.13	1.13
30.00	6.32	6.32	6.31	6.32	0.01	46.48	40.23	44.89	1.05	1.09	1.09	1.09	1.09
50.00	6.34	6.34	6.34	6.35	0.01	43.68	39.45	41.92	1.05	1.09	1.09	1.09	1.10
100.00	6.39	6.39	6.39	6.38	0.01	38.83	37.13	36.88	1.07	1.09	1.10	1.10	1.10
130.00	6.44	6.43	6.43	6.43	0.01	36.86	35.97	34.90	1.05	1.09	1.08	1.08	1.08
150.00	6.47	6.46	6.47	6.46	0.01	35.87	35.35	33.83	1.05	1.08	1.08	1.08	1.08
180.00	6.44	6.44	6.43	6.43	0.01	34.55	34.35	32.40	1.08	1.08	1.09	1.10	1.10
200.00	6.50	6.51	6.49	6.48	0.03	33.82	33.88	31.75	1.08	1.07	1.07	1.09	1.09
230.00	6.53	6.54	6.52	6.51	0.03	32.96	33.12	30.74	1.06	1.06	1.04	1.05	1.05
250.00	6.55	6.56	6.55	6.53	0.03	32.54	32.76	30.22	1.08	1.06	1.06	1.06	1.06
290.00	6.59	6.59	6.59	6.58	0.02	31.75	32.00	29.34	1.10	1.05	1.05	1.07	1.07
350.00	6.63	6.64	6.62	6.60	0.04	31.02	31.24	28.37	1.11	1.03	1.04	1.04	1.04
400.00	6.69	6.72	6.68	6.67	0.05	30.73	30.84	27.85	1.10	1.02	1.01	1.03	1.03
450.00	6.69	6.72	6.71	6.67	0.05	30.66	30.70	27.53	1.14	1.01	1.01	1.03	1.03
500.00	6.77	6.81	6.79	6.75	0.06	30.85	30.77	27.37	1.11	1.01	1.02	1.01	1.02

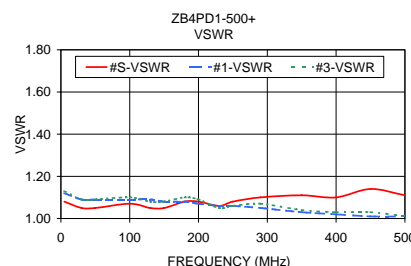
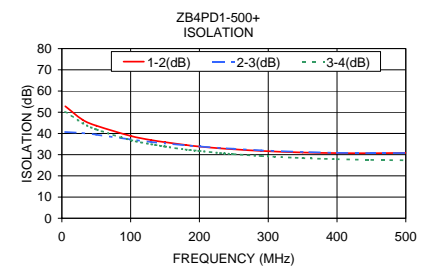
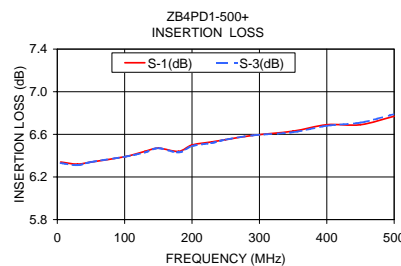

electrical schematic



For detailed performance specs & shopping online see web site

Mini-Circuits®
ISO 9001 ISO 14001 AS 9100 CERTIFIED

P.O. Box 350166, Brooklyn, New York 11235-0003 (718) 934-4500 Fax (718) 332-4661 The Design Engineers Search Engine Provides ACTUAL Data Instantly at minicircuits.com

IF/RF MICROWAVE COMPONENTS

Notes: 1. Performance and quality attributes and conditions not expressly stated in this specification sheet are intended to be excluded and do not form a part of this specification sheet. 2. Electrical specifications and performance data contained herein are based on Mini-Circuit's applicable established test performance criteria and measurement instructions. 3. The parts covered by this specification sheet are subject to Mini-Circuits standard limited warranty and terms and conditions (collectively, "Standard Terms"); Purchasers of this part are entitled to the rights and benefits contained therein. For a full statement of the Standard Terms and the exclusive rights and remedies thereunder, please visit www.minicircuits.com/MC/StandardTerms.

REV. D
M121747
ZB4PD1-500+
HY/TD/CP/AM
090827