

DC Pass Power Splitter/Combiner

ZB4PD1-152-75+

4 Way-0° 75Ω 650 to 1500 MHz

Maximum Ratings

Operating Temperature	-55°C to 100°C
Storage Temperature	-55°C to 100°C
Power Input (as a splitter)	10W max.
Internal Dissipation	0.375W max.

Permanent damage may occur if any of these limits are exceeded.

Coaxial Connections

SUM PORT	S
PORT 1	1
PORT 2	2
PORT 3	3
PORT 4	4

Outline Drawing

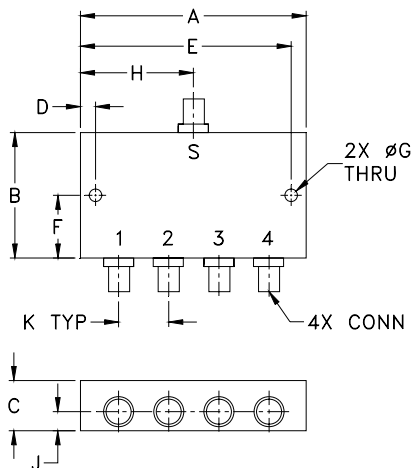

Outline Dimensions (inch/mm)

A	B	C	D	E	F	
3.50	2.13	.88	.150	3.350	1.06	
88.90	54.10	22.35	3.81	85.09	26.92	
G	H	J	K			wt
.125	1.75	.44	.89			grams
3.18	44.45	11.18	22.61			260

Features

- high isolation, 23 dB typ.
- rugged shielded case
- very good VSWR, 1.10:1 typ.
- up to 10W power input as a splitter
- DC current pass from outputs to S port 1.25A each port max.

Applications

- cellular
- communication systems
- receivers/transmitters

Electrical Specifications

FREQ. RANGE (MHz)	ISOLATION (dB)		INSERTION LOSS (dB) ABOVE 6.0 dB		PHASE UNBALANCE (Degrees)	AMPLITUDE UNBALANCE (dB)	VSWR (:1)			
	Typ.	Min.	Typ.	Max.			S	OUT		
f_c - f_u					Max.	Max.	Typ.	Max.	Typ.	Max.
650-1500	23	18	0.6	1.2	6	0.4	1.20	1.5	1.15	1.30

Typical Performance Data

Freq. (MHz)	Insertion Loss (dB)				Amp. Unbal. (dB)	Isolation (dB)			Phase Unbal. deg.	VSWR S	VSWR 1	VSWR 2	VSWR 3	VSWR 4
	S-1	S-2	S-3	S-4		1-2	2-3	3-4						
650.00	6.42	6.31	6.31	6.43	0.12	20.81	26.97	21.04	1.18	1.21	1.13	1.09	1.09	1.12
670.00	6.45	6.34	6.34	6.46	0.12	21.83	28.00	22.08	1.23	1.23	1.13	1.09	1.09	1.12
700.00	6.50	6.38	6.39	6.51	0.13	23.48	29.59	23.74	1.28	1.25	1.13	1.09	1.09	1.12
750.00	6.52	6.40	6.41	6.54	0.13	26.33	31.37	26.57	1.34	1.25	1.12	1.09	1.08	1.12
800.00	6.51	6.39	6.41	6.53	0.14	28.30	30.90	28.43	1.40	1.21	1.11	1.08	1.08	1.11
900.00	6.46	6.36	6.37	6.47	0.11	24.70	27.58	24.68	1.50	1.10	1.08	1.08	1.07	1.08
1000.00	6.61	6.53	6.53	6.61	0.08	21.39	25.85	21.44	1.83	1.25	1.07	1.10	1.10	1.07
1100.00	6.74	6.66	6.66	6.73	0.08	21.27	26.00	21.37	2.39	1.40	1.08	1.12	1.11	1.08
1200.00	6.59	6.47	6.47	6.59	0.12	24.09	28.21	24.18	2.89	1.38	1.08	1.10	1.10	1.10
1250.00	6.49	6.36	6.35	6.49	0.14	25.82	30.91	25.78	3.00	1.29	1.09	1.09	1.09	1.11
1300.00	6.49	6.32	6.31	6.49	0.18	25.63	35.26	25.39	3.04	1.19	1.11	1.07	1.08	1.13
1350.00	6.61	6.42	6.40	6.59	0.21	23.83	38.31	23.62	3.10	1.13	1.14	1.07	1.08	1.15
1400.00	6.77	6.57	6.54	6.74	0.22	22.39	33.30	22.26	3.11	1.19	1.16	1.07	1.08	1.16
1450.00	6.89	6.69	6.66	6.85	0.23	21.99	28.77	21.92	3.27	1.28	1.18	1.09	1.09	1.17
1500.00	6.88	6.69	6.65	6.84	0.22	22.79	25.67	22.86	3.39	1.33	1.18	1.09	1.09	1.17

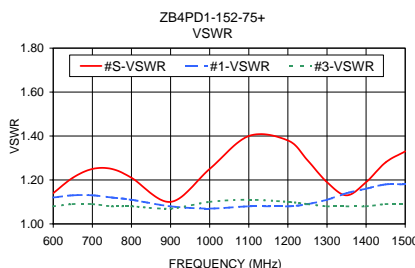
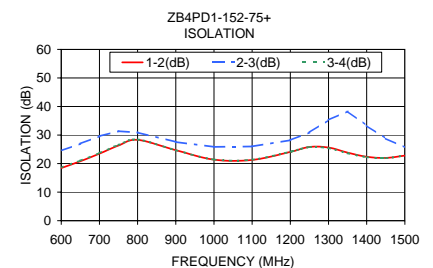
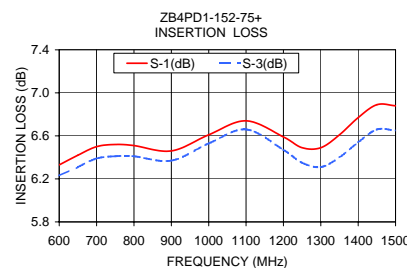

electrical schematic



For detailed performance specs & shopping online see web site

Mini-Circuits®
ISO 9001 ISO 14001 AS 9100 CERTIFIED
IFIRF MICROWAVE COMPONENTS

P.O. Box 350166, Brooklyn, New York 11235-0003 (718) 934-4500 Fax (718) 332-4661 The Design Engineers Search Engine Provides ACTUAL Data Instantly at minicircuits.com

Notes: 1. Performance and quality attributes and conditions not expressly stated in this specification sheet are intended to be excluded and do not form a part of this specification sheet. 2. Electrical specifications and performance data contained herein are based on Mini-Circuit's applicable established test performance criteria and measurement instructions. 3. The parts covered by this specification sheet are subject to Mini-Circuits standard limited warranty and terms and conditions (collectively, "Standard Terms"); Purchasers of this part are entitled to the rights and benefits contained therein. For a full statement of the Standard Terms and the exclusive rights and remedies thereunder, please visit Mini-Circuits' website at www.minicircuits.com/MCLStore/terms.jsp.

REV. OR
M112749
ED-12861/1
ZB4PD1-152-75+
HY/CP/AM
090827