

Coaxial

Power Splitter/Combiner

ZB4PD-6.4A+

4 Way-0° 50Ω 5400 to 6800 MHz

Maximum Ratings

Operating Temperature	-55°C to 100°C
Storage Temperature	-55°C to 100°C
Power Input (as a splitter)	10W max.
Internal Dissipation	0.375W max.

Permanent damage may occur if any of these limits are exceeded.

Coaxial Connections

SUM PORT	S
PORT 1	1
PORT 2	2
PORT 3	3
PORT 4	4

Outline Drawing

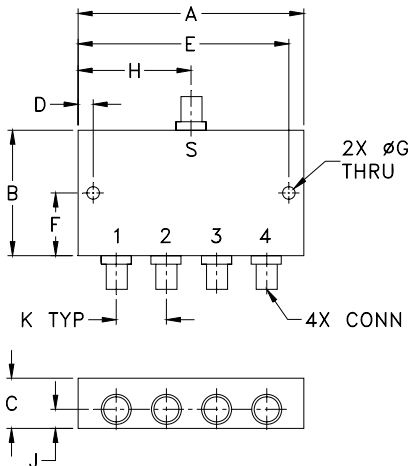

Outline Dimensions (inch/mm)

A	B	C	D	E	F
3.50	2.13	.88	.150	3.350	1.06
88.90	54.10	22.35	3.81	85.09	26.92
G	H	J	K	wt	
.125	1.75	.44	.89	grams	
3.18	44.45	11.18	22.61	260	

Features

- wideband, 5400 to 6800 MHz
- good isolation, 25 dB typ.
- rugged, shielded case

Applications

- satellite communications
- receivers/transmitters



CASE STYLE: UU188

Connectors	Model	Price	Qty.
N-Type	ZB4PD-6.4A-N+	\$99.95	(1-9)

+ RoHS compliant in accordance with EU Directive (2002/95/EC)

The +Suffix has been added in order to identify RoHS Compliance. See our web site for RoHS Compliance methodologies and qualifications.

Electrical Specifications

Parameter	Frequency (MHz)	Min.	Typ.	Max.	Unit
Frequency Range		5400	—	6800	MHz
Insertion Loss Above 6.0 dB	5400-6800	—	0.6	1.2	dB
Isolation	5400-6800	18	25	—	dB
Phase Unbalance	5400-6800	—	—	9.0	Degree
Amplitude Unbalance	5400-6800	—	—	0.9	dB
VSWR Input	5400-6800	—	1.30	1.50	:1
VSWR Output	5400-6800	—	1.30	1.50	:1

Typical Performance Data

Freq. (MHz)	Total Loss ¹ (dB)				Amp. Unbal. (dB)	Isolation (dB)			VSWR S	VSWR 1	VSWR 2	VSWR 3	VSWR 4
	S-1	S-2	S-3	S-4		1-2	2-3	3-4					
5400.00	6.48	6.46	6.44	6.42	0.07	28.53	29.05	28.62	1.09	1.13	1.16	1.12	1.12
5500.00	6.48	6.45	6.44	6.42	0.06	27.79	30.48	28.08	1.07	1.11	1.14	1.11	1.12
5600.00	6.48	6.44	6.44	6.42	0.06	26.95	32.07	27.32	1.06	1.09	1.12	1.10	1.10
5700.00	6.49	6.45	6.44	6.44	0.05	26.28	33.78	26.66	1.06	1.07	1.08	1.07	1.09
5800.00	6.50	6.45	6.44	6.44	0.06	25.87	35.42	26.19	1.06	1.04	1.05	1.05	1.07
5900.00	6.53	6.46	6.46	6.46	0.08	25.84	36.67	26.13	1.07	1.02	1.01	1.03	1.05
6000.00	6.56	6.48	6.48	6.49	0.08	26.21	37.04	26.44	1.11	1.03	1.03	1.04	1.04
6200.00	6.63	6.53	6.53	6.54	0.11	28.71	35.60	28.91	1.18	1.08	1.10	1.08	1.06
6300.00	6.66	6.55	6.55	6.57	0.12	31.45	34.61	31.66	1.20	1.10	1.13	1.10	1.08
6400.00	6.69	6.57	6.56	6.60	0.13	36.30	33.76	36.63	1.19	1.11	1.14	1.11	1.08
6500.00	6.71	6.58	6.58	6.62	0.13	43.03	33.09	42.66	1.17	1.12	1.15	1.11	1.08
6600.00	6.72	6.59	6.59	6.64	0.14	35.93	32.62	35.45	1.13	1.11	1.14	1.11	1.07
6700.00	6.74	6.60	6.60	6.66	0.14	30.49	32.36	30.19	1.07	1.10	1.13	1.10	1.07
6750.00	6.75	6.60	6.61	6.67	0.14	28.71	32.31	28.45	1.05	1.10	1.13	1.10	1.08
6800.00	6.76	6.62	6.62	6.68	0.14	27.19	32.31	26.97	1.05	1.10	1.13	1.10	1.09

1. Total Loss = Insertion Loss + 6dB splitter loss.

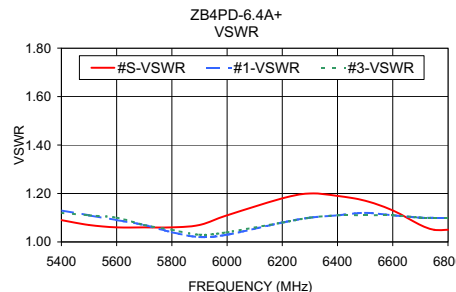
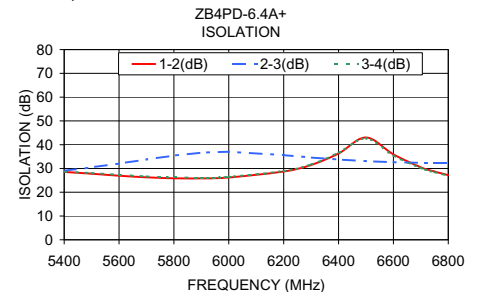
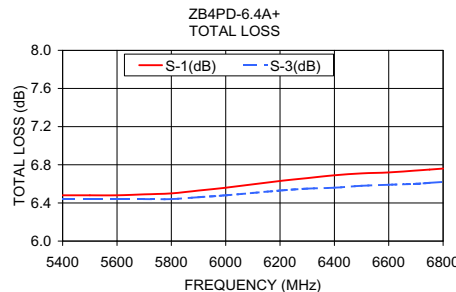

electrical schematic



For detailed performance specs & shopping online see web site

P.O. Box 350166, Brooklyn, New York 11235-0003 (718) 934-4500 Fax (718) 332-4661 The Design Engineers Search Engine Provides ACTUAL Data Instantly at minicircuits.com

Notes: 1. Performance and quality attributes and conditions not expressly stated in this specification sheet are intended to be excluded and do not form a part of this specification sheet. 2. Electrical specifications and performance data contained herein are based on Mini-Circuit's applicable established test performance criteria and measurement instructions. 3. The parts covered by this specification sheet are subject to Mini-Circuits standard limited warranty and terms and conditions (collectively, "Standard Terms"); Purchasers of this part are entitled to the rights and benefits contained therein. For a full statement of the Standard Terms and the exclusive rights and remedies thereunder, please visit Mini-Circuits' website at www.minicircuits.com/MCLStore/terms.jsp.

REV. OR
M126153
ZB4PD-6.4A+
ED-5336A/1
HY/CP/AM
110912