

DC Pass

Directional Coupler

ZADC-6-2G-5W+

50Ω up to 5W 800 to 2000 MHz



Maximum Ratings

Operating Temperature	-55°C to 100°C
Storage Temperature	-55°C to 100°C
DC Current	1.0A

Permanent damage may occur if any of these limits are exceeded.

Coaxial Connections

INPUT	1
OUTPUT	3
COUPLED	2

Features

- wideband, 800-2000 MHz
- low mainline loss, 1.5 dB typ.
- good directivity, 22 dB typ.
- good power handling, 5W max.
- DC current through input to output 1.0A Max.

Applications

- AMPS/GSM
- PCS/DCS
- ISM/GPS

CASE STYLE: CC51-1

Connectors	Model	Price	Qty.
SMA	ZADC-6-2G-5W-S+	\$54.95 ea.	(1-9)

+ RoHS compliant in accordance with EU Directive (2002/95/EC)

The +Suffix has been added in order to identify RoHS Compliance. See our web site for RoHS Compliance methodologies and qualifications.

Directional Coupler Electrical Specifications

FREQ. RANGE (MHz)	COUPLING (dB)		MAINLINE LOSS ¹ (dB)		DIRECTIVITY (dB)		VSWR (:1)	POWER INPUT (W) Max.
	Nom.	Flatness	Typ.	Max.	Typ.	Min.		
800-1000	6.7±1.0	±0.7	1.3	1.6	35	20	1.15	5
1700-2000	6.7±1.0	±1.0	1.3	1.8	22	17	1.15	5
800-2000	6.7±1.0	±1.3	1.6	1.9	25	17	1.15	5

1. Mainline loss includes theoretical power loss at coupled port.

Outline Drawing

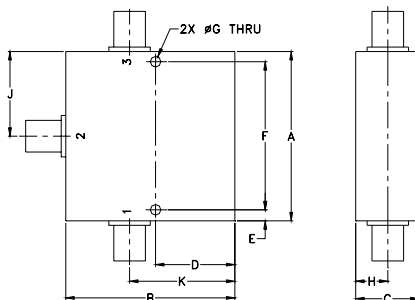

Outline Dimensions (inch/mm)

A	B	C	D	E	F			
2.00	2.00	.75	.938	.13	1.750			
50.80	50.80	19.05	23.83	3.30	44.45			
G	H	J	K			wt		
.125	.38	1.00	1.25			grams		
3.18	9.65	25.40	31.75			145.0		

Typical Performance Data

Frequency (MHz)	Mainline Loss (dB) In-Out	Coupling (dB) In-Cpl	Directivity (dB)	Return Loss (dB)		
				In	Out	Cpl
800.00	1.08	7.35	34.57	31.46	28.00	31.82
900.00	1.23	6.80	33.05	30.33	26.86	32.77
1050.00	1.43	6.22	30.44	29.07	25.50	38.53
1200.00	1.57	5.87	28.24	28.76	24.40	52.27
1350.00	1.64	5.72	26.23	29.40	24.00	32.86
1450.00	1.65	5.73	24.80	30.92	24.43	27.94
1600.00	1.60	5.90	23.21	33.42	25.80	23.38
1750.00	1.48	6.30	21.99	40.23	28.68	20.45
1900.00	1.32	6.93	20.97	34.51	29.80	18.89
2000.00	1.19	7.52	20.58	28.75	26.56	18.21

ZADC-6-2G-5W+ MAINLINE LOSS

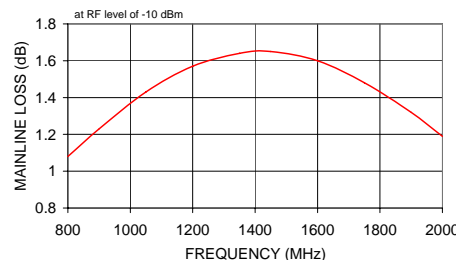

ZADC-6-2G-5W+ COUPLING & DIRECTIVITY

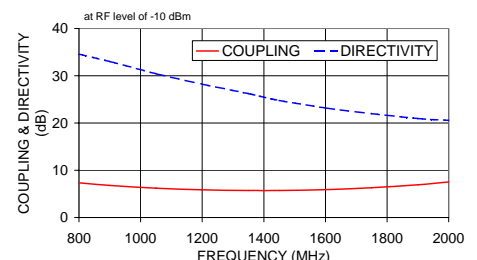

ZADC-6-2G-5W+ RETURN LOSS

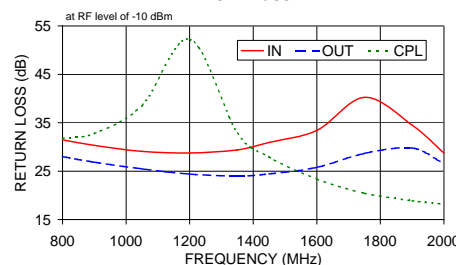

Electrical Schematic

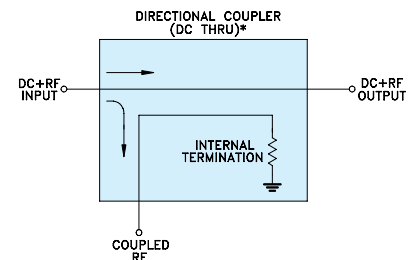

* ELECTRICAL SCHEMATIC FOR DIRECTIONAL COUPLER THAT IS DESIGNED WITHOUT INTERNAL TRANSFORMERS.

For detailed performance specs & shopping online see web site



P.O. Box 350166, Brooklyn, New York 11235-0003 (718) 934-4500 Fax (718) 332-4661 The Design Engineers Search Engine Provides ACTUAL Data Instantly at minicircuits.com

Notes: 1. Performance and quality attributes and conditions not expressly stated in this specification sheet are intended to be excluded and do not form a part of this specification sheet. 2. Electrical specifications and performance data contained herein are based on Mini-Circuit's applicable established test performance criteria and measurement instructions. 3. The parts covered by this specification sheet are subject to Mini-Circuits standard limited warranty and terms and conditions (collectively, "Standard Terms"); Purchasers of this part are entitled to the rights and benefits contained therein. For a full statement of the Standard Terms and the exclusive rights and remedies thereunder, please visit Mini-Circuits' website at www.minicircuits.com/MCLStore/terms.jsp.

REV. C
M119986
ED-12145/1
ZADC-6-2G-5W
WZ/LC/CP/AM
090915