

DC Pass Bi-Directional Coupler

50Ω Up to 100W 800 to 2500 MHz

ZABDC20-252H+



SMA version shown
CASE STYLE: DD477-1

Connectors	Model	Price	Qty.
SMA	ZABDC20-252H-S+	\$119.95	(1-9)
N-TYPE	ZABDC20-252H-N+	\$129.95	(1-9)

+ RoHS compliant in accordance with EU Directive (2002/95/EC)

The +Suffix has been added in order to identify RoHS Compliance. See our web site for RoHS Compliance methodologies and qualifications.

Maximum Ratings

Operating Temperature	-55°C to 100°C
Storage Temperature	-55°C to 100°C
DC Current	2.0 A

* Case temperature is defined as temperature on ground leads. Permanent damage may occur if any of these limits are exceeded.

Coaxial Connections

INPUT	1
OUTPUT	4
COUPLED (forward)	2
COUPLED (reverse)	3

Outline Drawing

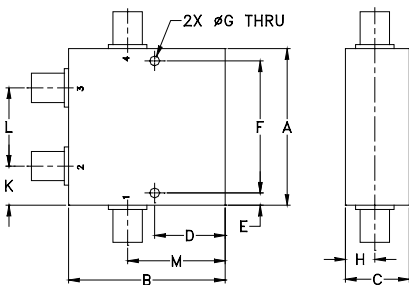

Outline Dimensions (inch/mm)

A	B	C	D	E	F	G	
2.00	2.00	.88	.90	.156	1.688	.125	
50.80	50.80	22.35	22.86	3.96	42.88	3.18	
H	J	K	L	M		wt	
.38	---	.50	1.00	1.25		grams	
9.65	---	12.70	25.40	31.75		225	

Features

- excellent mainline loss, 0.17 dB typ.
- excellent directivity, 28 dB typ.
- high power, up to 100W
- rugged shielded case
- DC current through input to output 2.0A Max. at 50 watt RF input power

Applications

- PCS/DCS/UMTS
- power leveling & monitoring
- VSWR measurement

Bi-Directional Coupler Electrical Specifications

FREQ. (MHz)	COUPLING (dB)		MAINLINE LOSS' (dB)		DIRECTIVITY (dB)		VSWR (:1)	POWER INPUT (W)
	Norm.	Flatness	Typ.	Max.	Typ.	Min.		
f_L - f_U								
800-2500			0.20	0.35			1.05	50
800-1000	23±1.0	±0.9	0.15	0.25	30	23	1.05	100
1300-2500	19.7±0.7	±0.75	0.20	0.35	28	20	1.05	50

1. Mainline loss includes theoretical power loss at coupled port.

Typical Performance Data

Frequency (MHz)	Mainline Loss (dB)		Coupling (dB)		Directivity (dB)		Return Loss (dB)		
	In-Out	In-Cpl Fwd	In-Cpl Rev	Out-Cpl Rev	Out-Cpl Fwd	In-Cpl Rev	In	Out	Cpl Fwd
800.00	0.11	23.88	23.85	32.78	36.66	39.78	35.40	47.06	42.20
1000.00	0.12	22.32	22.28	30.17	32.23	39.27	35.77	38.27	37.38
1200.00	0.13	21.22	21.15	31.42	32.87	35.59	36.09	34.59	34.96
1400.00	0.15	20.43	20.38	35.46	36.13	32.74	34.79	33.78	35.02
1600.00	0.17	19.92	19.86	42.35	35.55	30.21	33.34	31.94	33.00
1800.00	0.19	19.63	19.58	32.79	29.28	29.43	33.84	33.22	32.26
2000.00	0.20	19.58	19.54	28.91	26.99	30.64	33.90	36.72	35.98
2200.00	0.21	19.77	19.73	28.11	26.09	31.14	35.70	41.69	36.37
2400.00	0.21	20.21	20.16	27.14	25.13	35.33	36.16	49.29	35.25
2500.00	0.21	20.53	20.48	27.45	24.97	37.60	37.56	38.44	34.58

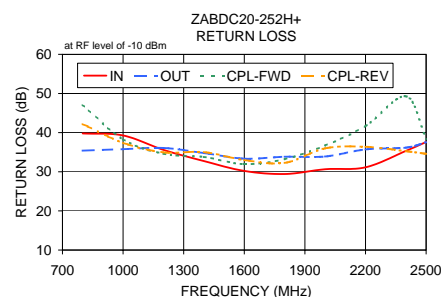
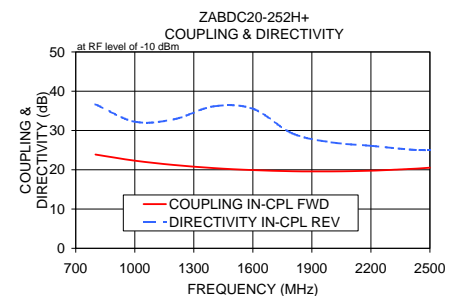
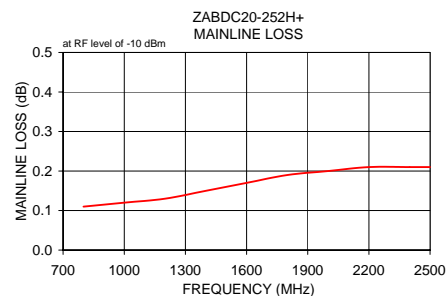

Electrical Schematic

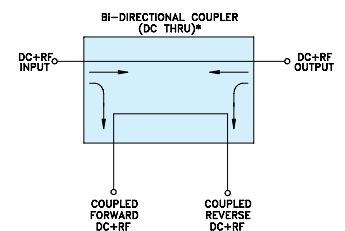

* ELECTRICAL SCHEMATIC IS FOR BI-DIRECTIONAL COUPLER WITHOUT INTERNAL TRANSFORMERS AND RESISTORS.

For detailed performance specs & shopping online see web site

Mini-Circuits
ISO 9001 ISO 14001 AS 9100 CERTIFIED
P.O. Box 350166, Brooklyn, New York 11235-0003 (718) 934-4500 Fax (718) 332-4661 The Design Engineers Search Engine Provides ACTUAL Data Instantly at minicircuits.com

IF/RF MICROWAVE COMPONENTS

Notes: 1. Performance and quality attributes and conditions not expressly stated in this specification sheet are intended to be excluded and do not form a part of this specification sheet. 2. Electrical specifications and performance data contained herein are based on Mini-Circuit's applicable established test performance criteria and measurement instructions. 3. The parts covered by this specification sheet are subject to Mini-Circuits standard limited warranty and terms and conditions (collectively, "Standard Terms"); Purchasers of this part are entitled to the rights and benefits contained therein. For a full statement of the Standard Terms and the exclusive rights and remedies thereunder, please visit Mini-Circuits' website at www.minicircuits.com/MCLStore/terms.jsp.

REV. B
M119986
ED-11579/4
ZABDC20-252H+
WP/QL/AM
090915