

DC Pass

Bi-Directional Coupler

ZABDC20-2400

50Ω Up to 10W 1500 to 2400 MHz

Maximum Ratings

Operating Temperature	-55°C to 100°C
Storage Temperature	-55°C to 100°C
DC Current	1.0A

* Case temperature is defined as temperature on ground leads.
Permanent damage may occur if any of these limits are exceeded.

Coaxial Connections

INPUT	1
OUTPUT	4
COUPLED (forward)	2
COUPLED (reverse)	3

Outline Drawing

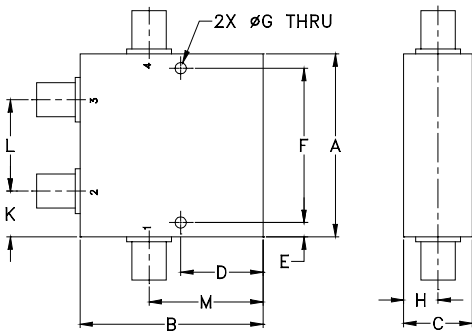

Outline Dimensions (inch/mm)

A	B	C	D	E	F	G
2.00	2.00	.75	.90	.156	1.688	.125
50.80	50.80	19.05	22.86	3.96	42.88	3.18
H	J	K	L	M		wt
.38	---	.50	1.00	1.25		grams
9.65	---	12.70	25.40	31.75		145

Features

- excellent directivity, 25 dB typ.
- low mainline loss, 0.3 dB typ.
- high power, up to 10W
- rugged shielded case
- DC current through input to output 1.0A Max. at 1.0 watt RF input power.

Applications

- PCS/DCS/UMTS
- power leveling & monitoring
- VSWR measurement



CASE STYLE: DD477

Connectors	Model	Price	Qty.
SMA	ZABDC20-2400-S	\$89.95 ea.	(1-9)

Bi-Directional Coupler Electrical Specifications

FREQ. RANGE (MHz)	COUPLING (dB)		MAINLINE LOSS ¹ (dB)		DIRECTIVITY (dB)		VSWR (:1)	POWER INPUT (W)
	Norm.	Flatness	Typ.	Max.	Typ.	Min.		
1500-2400	19.5±1.0	±1.0	0.3	0.5	25	18	1.2	10

1. Mainline loss includes theoretical power loss at coupled port.

Typical Performance Data

Frequency (MHz)	Mainline Loss (dB)		Coupling (dB)	Directivity (dB)	Return Loss (dB)		
	In-Out	In-Cpl			In	Out	Cpl
1500.00	0.19	19.90	23.45	27.51	28.35	24.98	
1588.00	0.21	19.75	24.21	28.25	29.14	25.69	
1676.00	0.23	19.63	25.06	29.19	30.06	26.19	
1764.00	0.25	19.59	25.82	30.29	31.05	26.11	
1852.00	0.25	19.56	26.41	31.74	32.30	25.22	
1964.00	0.32	19.62	26.62	34.28	34.41	23.34	
2084.00	0.33	19.65	25.86	38.45	37.76	21.21	
2202.00	0.30	19.71	24.82	43.89	43.16	19.38	
2312.00	0.29	19.85	23.81	42.07	48.30	18.05	
2400.00	0.31	19.93	23.26	38.87	48.51	17.31	

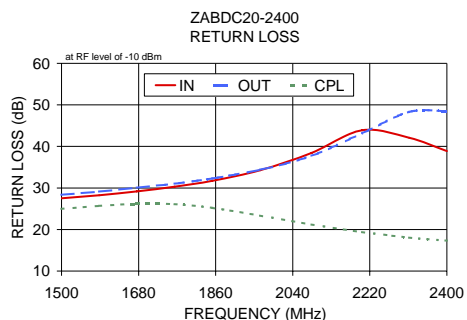
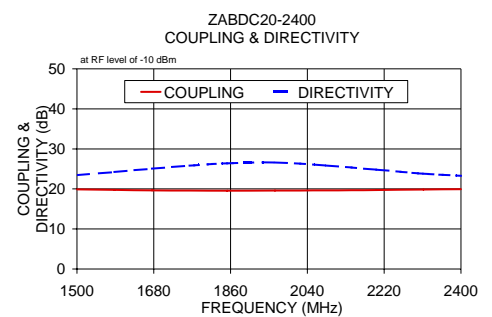
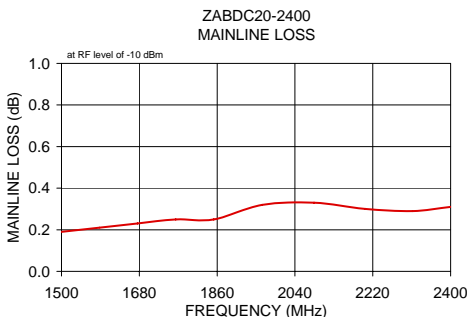

Electrical Schematic

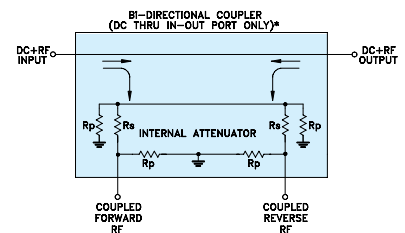

* ELECTRICAL SCHEMATIC IS FOR BI-DIRECTIONAL COUPLER WITH INTERNAL ATTENUATORS AT COUPLING PORTS.



For detailed performance specs & shopping online see web site

P.O. Box 350166, Brooklyn, New York 11235-0003 (718) 934-4500 Fax (718) 332-4661 The Design Engineers Search Engine Provides ACTUAL Data Instantly at minicircuits.com

Notes: 1. Performance and quality attributes and conditions not expressly stated in this specification sheet are intended to be excluded and do not form a part of this specification sheet. 2. Electrical specifications and performance data contained herein are based on Mini-Circuit's applicable established test performance criteria and measurement instructions. 3. The parts covered by this specification sheet are subject to Mini-Circuits standard limited warranty and terms and conditions (collectively, "Standard Terms"); Purchasers of this part are entitled to the rights and benefits contained therein. For a full statement of the Standard Terms and the exclusive rights and remedies thereunder, please visit Mini-Circuits' website at www.minicircuits.com/MCLStore/terms.jsp.

REV. C
M119986
ZABDC20-2400
WP/TD/CP/AM
090915