

Coaxial High Power Combiner

ZA2CS-500-15W

2 Way-0° 50Ω 200 to 500 MHz

Maximum Ratings

Operating Temperature	-55°C to 90°C
Storage Temperature	-55°C to 100°C

Permanent damage may occur if any of these limits are exceeded.

Coaxial Connections

SUM PORT	S
PORT 1	1
PORT 2	2

Outline Drawing

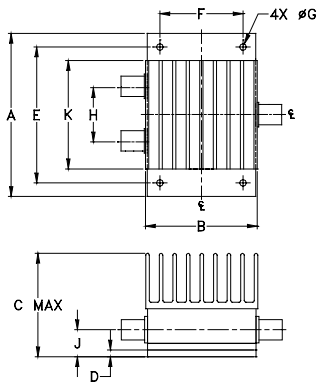

Outline Dimensions (inch/mm)

A	B	C	D	E	F	
3.00	2.06	1.92	.100	2.500	1.525	
76.20	52.32	48.77	2.54	63.50	38.74	
G	H	J	K			wt
.125	1.000	.50	2.00			grams
3.18	25.40	12.70	50.80			330

Features

- high power, up to 15W input power
- wideband, 200 to 500 MHz
- high isolation, 31 dB typ.

Applications

- communication systems
- VHF transmitters



BNC version shown
CASE STYLE: AW254

Connectors	Model	Price	Qty.
BNC	ZA2CS-500-15W	\$74.95	(1-9)
N-TYPE	ZA2CS-500-15W-N	\$79.95	(1-9)
SMA	ZA2CS-500-15W-S	\$79.95	(1-9)

High Power Combiner Electrical Specifications

FREQ. RANGE (MHz)	ISOLATION (dB)		INSERTION LOSS (dB) ABOVE 3.0 dB		PHASE UNBALANCE (Degrees)		AMPLITUDE UNBALANCE (dB)		POWER INPUT ¹ (W)	
	Typ.	Min.	Typ.	Max.	Typ.	Max.	Typ.	Max.	as combiner ² Max.	as splitter Max.
200-500	31	20	0.3	1.0	0.3	3.0	0.10	0.4	15	15

1. Over -55°C to +55°C. Derate linearly to 20% of rating at 90°C
2. As a combiner of non-coherent signals, max. power per port is power rating divided by number of ports.

Typical Performance Data

Frequency (MHz)	Insertion Loss (dB)		Amplitude Unbalance (dB)	Isolation (dB)	Phase Unbalance (deg.)	VSWR S	VSWR 1	VSWR 2
	S-1	S-2						
200.00	3.23	3.26	0.03	28.38	0.31	1.15	1.14	1.13
212.00	3.21	3.26	0.06	29.33	0.50	1.11	1.13	1.11
224.00	3.21	3.29	0.09	30.25	0.19	1.04	1.12	1.10
248.00	3.24	3.29	0.05	31.59	0.27	1.10	1.09	1.08
272.00	3.26	3.31	0.05	32.52	0.20	1.10	1.07	1.06
296.00	3.28	3.33	0.05	33.68	0.29	1.10	1.06	1.04
320.00	3.29	3.35	0.06	35.77	0.36	1.08	1.06	1.04
344.00	3.32	3.36	0.04	37.47	0.44	1.14	1.06	1.04
368.00	3.34	3.39	0.06	37.28	0.29	1.12	1.06	1.05
392.00	3.35	3.40	0.05	36.55	0.41	1.12	1.07	1.06
416.00	3.35	3.43	0.08	35.98	0.09	1.03	1.09	1.07
440.00	3.39	3.44	0.05	34.82	0.24	1.04	1.10	1.09
464.00	3.40	3.46	0.05	33.24	0.33	1.11	1.12	1.10
488.00	3.44	3.53	0.09	31.48	0.35	1.12	1.14	1.12
500.00	3.42	3.53	0.10	30.63	0.30	1.12	1.14	1.13

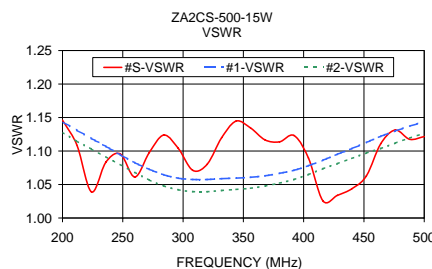
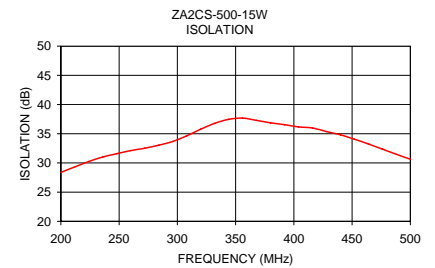
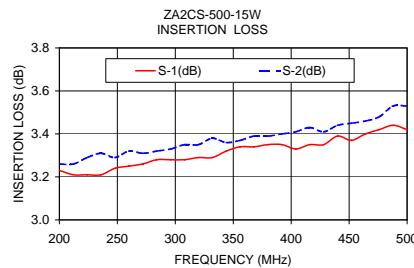

electrical schematic

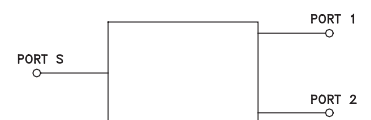

For detailed performance specs & shopping online see web site

P.O. Box 350166, Brooklyn, New York 11235-0003 (718) 934-4500 Fax (718) 332-4661 The Design Engineers Search Engine Provides ACTUAL Data Instantly at minicircuits.com

Notes: 1. Performance and quality attributes and conditions not expressly stated in this specification sheet are intended to be excluded and do not form a part of this specification sheet. 2. Electrical specifications and performance data contained herein are based on Mini-Circuit's applicable established test performance criteria and measurement instructions. 3. The parts covered by this specification sheet are subject to Mini-Circuits standard limited warranty and terms and conditions (collectively, "Standard Terms"); Purchasers of this part are entitled to the rights and benefits contained therein. For a full statement of the Standard Terms and the exclusive rights and remedies thereunder, please visit Mini-Circuits' website at www.minicircuits.com/MCLStore/terms.jsp.

REV. A
M118941
ZA2CS-500-15W
HY/TD/CP
090827