

# Coaxial High Power Combiner

## ZA2CS-10-20W

2 Way-0° 50Ω 900 to 1000 MHz

### Maximum Ratings

Operating Temperature	-55°C to 90°C
Storage Temperature	-55°C to 100°C

Permanent damage may occur if any of these limits are exceeded.

### Coaxial Connections

SUM PORT	S
PORT 1	1
PORT 2	2

### Outline Drawing

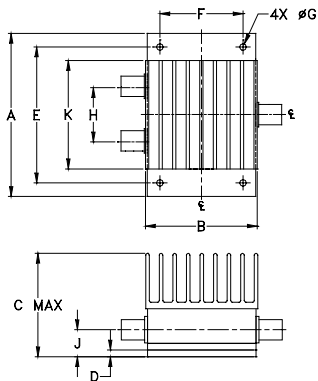

### Outline Dimensions (inch/mm)

A	B	C	D	E	F	
3.00	2.06	1.92	.100	2.500	1.525	
76.20	52.32	48.77	2.54	63.50	38.74	
G	H	J	K			wt
.125	1.000	.50	2.00			grams
3.18	25.40	12.70	50.80			330

### Features

- high power, up to 20W input power
- low insertion loss, 0.2 dB typ.
- high isolation, 38 dB typ.
- excellent VSWR, 1.1:1 typ.

### Applications

- cellular
- instrumentation
- communication transmitters & receivers



CASE STYLE: AW254

Connectors	Model	Price	Qty.
N-TYPE	ZA2CS-10-20W-N	\$89.95	(1-9)

### High Power Combiner Electrical Specifications

FREQ. RANGE (MHz)	ISOLATION (dB)		INSERTION LOSS (dB) ABOVE 3.0 dB		PHASE UNBALANCE (Degrees)		AMPLITUDE UNBALANCE (dB)		POWER INPUT <sup>1</sup> (W)	
	Typ.	Min.	Typ.	Max.	Typ.	Max.	Typ.	Max.	as combiner <sup>2</sup> Max.	as splitter Max.
f <sub>L</sub> -f <sub>H</sub>										
900-1000	38	20	0.2	0.5	0.5	3.0	0.11	0.3	20	20

1. Over -55°C to +55°C. Derate linearly to 20% of rating at 90°C
2. As a combiner of non-coherent signals, max. power per port is power rating divided by number of ports.

### Typical Performance Data

Frequency (MHz)	Insertion Loss (dB)		Amplitude Unbalance (dB)	Isolation (dB)	Phase Unbalance (deg.)	VSWR S	VSWR 1	VSWR 2
	S-1	S-2						
900.00	3.23	3.22	0.01	24.81	0.25	1.29	1.17	1.17
908.00	3.21	3.19	0.02	25.59	0.27	1.27	1.16	1.16
914.00	3.20	3.18	0.02	26.22	0.27	1.25	1.16	1.16
920.00	3.20	3.17	0.02	26.94	0.26	1.24	1.15	1.15
930.00	3.19	3.18	0.02	28.21	0.27	1.21	1.14	1.14
940.00	3.19	3.17	0.02	29.70	0.23	1.19	1.14	1.13
950.00	3.19	3.17	0.02	31.38	0.29	1.18	1.13	1.13
960.00	3.19	3.17	0.02	33.33	0.28	1.17	1.13	1.12
970.00	3.19	3.16	0.03	35.50	0.24	1.16	1.12	1.12
980.00	3.20	3.17	0.03	37.24	0.25	1.15	1.12	1.11
986.00	3.20	3.17	0.03	37.77	0.23	1.14	1.11	1.11
993.00	3.20	3.17	0.03	37.35	0.27	1.13	1.11	1.10
996.00	3.20	3.17	0.03	36.92	0.25	1.12	1.11	1.10
998.00	3.20	3.17	0.03	36.59	0.23	1.12	1.10	1.10
1000.00	3.20	3.17	0.03	36.22	0.25	1.11	1.10	1.10

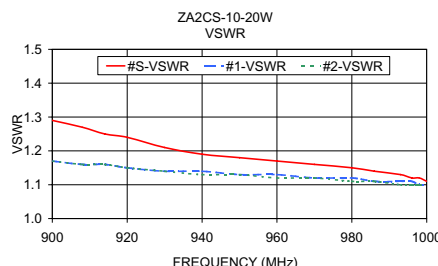
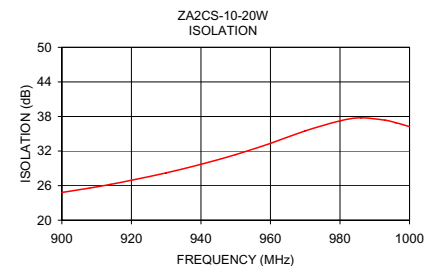
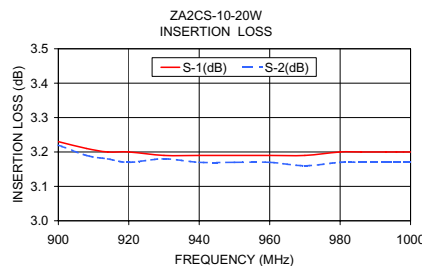

### electrical schematic

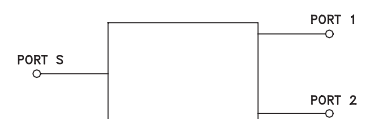

For detailed performance specs & shopping online see web site

P.O. Box 350166, Brooklyn, New York 11235-0003 (718) 934-4500 Fax (718) 332-4661 The Design Engineers Search Engine Provides ACTUAL Data Instantly at [minicircuits.com](http://minicircuits.com)

Notes: 1. Performance and quality attributes and conditions not expressly stated in this specification sheet are intended to be excluded and do not form a part of this specification sheet. 2. Electrical specifications and performance data contained herein are based on Mini-Circuit's applicable established test performance criteria and measurement instructions. 3. The parts covered by this specification sheet are subject to Mini-Circuits standard limited warranty and terms and conditions (collectively, "Standard Terms"); Purchasers of this part are entitled to the rights and benefits contained therein. For a full statement of the Standard Terms and the exclusive rights and remedies thereunder, please visit Mini-Circuits' website at [www.minicircuits.com/MCLStore/terms.jsp](http://www.minicircuits.com/MCLStore/terms.jsp).

REV. A  
M118941  
ED-6067/1  
ZA2CS-10-20W  
HY/TD/CP  
090827