

Termination N-Type

50Ω

DC to 8000 MHz

KARN-50+



Maximum Ratings

Operating Temperature	-55°C to 100°C
Storage Temperature	-55°C to 100°C

Permanent damage may occur if any of these limits are exceeded.

Features

- wideband coverage, DC to 8000 MHz
- useable to 9000 MHz (return loss, 20 dB typ. at 9000 MHz)
- rugged construction
- brass body with trimetal finish

Applications

- cellular communications
- satellite communications
- defense communications
- test set-up

CASE STYLE: LL718

Connectors	Model	Price	Qty.
N-Type-Male	KARN-50+	\$11.95 ea.	(1-9)

+ RoHS compliant in accordance with EU Directive (2002/95/EC)

The +Suffix has been added in order to identify RoHS Compliance. See our web site for RoHS Compliance methodologies and qualifications.

Outline Drawing

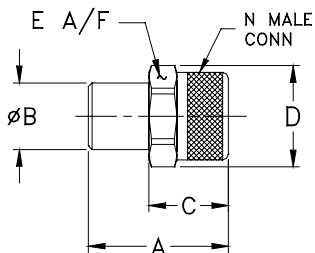

Outline Dimensions (inch/mm)

A	B	C	D	E	wt
1.18	0.56	0.67	0.85	0.787	grams
29.97	14.22	17.02	21.59	19.99	30.0



To order KARN-50+ with 3½ length chain and end coupling with .130" diameter mtg. hole, use part no. KARN-50CN+. Price is \$14.95, Qty. (1-9)

Electrical Specifications

FREQUENCY (MHz)	IMPEDANCE (OHMS)	RETURN LOSS (dB) MIN.					POWER RATING* (W)
		DC-.5 GHz	DC-1 GHz	DC-2 GHz	DC-4 GHz	DC-8 GHz	
DC-8000	50	30	30	29	27	20	2

*At 70°C, derate linearly at 0.025W/°C at 100°C.

Typical Performance Data

Frequency (MHz)	Return Loss (dB)
100	46.31
600	46.36
1000	44.26
2000	39.83
3000	37.27
4000	35.14
5000	33.72
6000	34.35
7000	34.72
8000	34.96

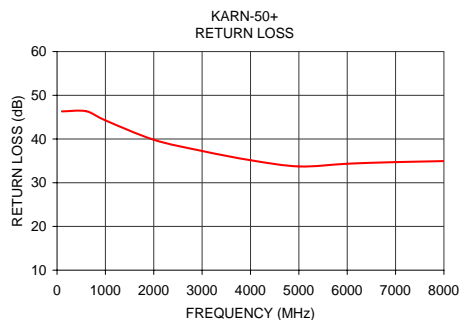

Mini-Circuits®
ISO 9001 ISO 14001 AS 9100 CERTIFIED

For detailed performance specs & shopping online see web site

P.O. Box 350166, Brooklyn, New York 11235-0003 (718) 934-4500 Fax (718) 332-4661 *The Design Engineers Search Engine* Provides ACTUAL Data Instantly at minicircuits.com

Notes: 1. Performance and quality attributes and conditions not expressly stated in this specification sheet are intended to be excluded and do not form a part of this specification sheet. 2. Electrical specifications and performance data contained herein are based on Mini-Circuit's applicable established test performance criteria and measurement instructions. 3. The parts covered by this specification sheet are subject to Mini-Circuits standard limited warranty and terms and conditions (collectively, "Standard Terms"); Purchasers of this part are entitled to the rights and benefits contained therein. For a full statement of the Standard Terms and the exclusive rights and remedies thereunder, please visit Mini-Circuits' website at www.minicircuits.com/MCLStore/terms.jsp.

REV. D
M98898
KARN-50+
ED-11480A
RS/TD/CP
070305